

Leigh Road, Atherton, M46 0PW
Offers Over £120,000

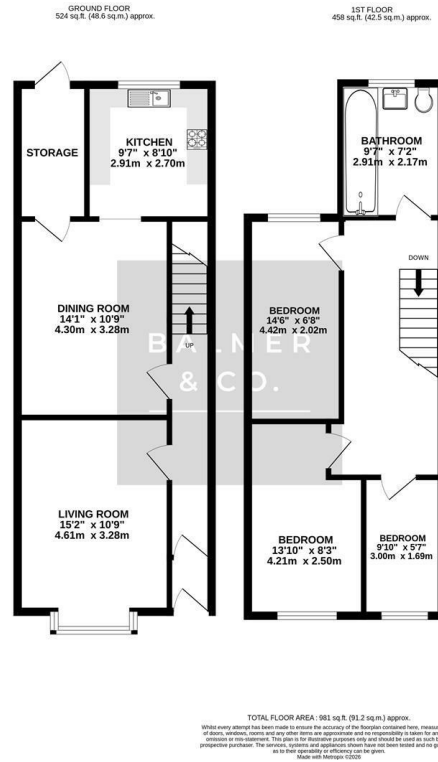

BALMER & CO in ATHERTON are delighted to offer FOR SALE this three bedroom mid terraced property, located on Leigh Road in the ever popular Howe Bridge area of Atherton. Although it is in need of refurbishment, it is a fantastic size with some lovely original features and is ideally offered with NO ONWARD CHAIN making it perfect for investors or those looking to add their own stamp to their home. The ground floor comprising in brief; entrance hallway, living room, dining room, fitted kitchen and a small storage room. To the first floor are three bedrooms as the master bedroom has been partitioned to make two bedrooms, and a three piece bathroom suite. Externally the property has a small garden frontage with an enclosed private yard to the rear. Early viewings highly recommended, all enquiries welcome.

Floor Plan



Area Map

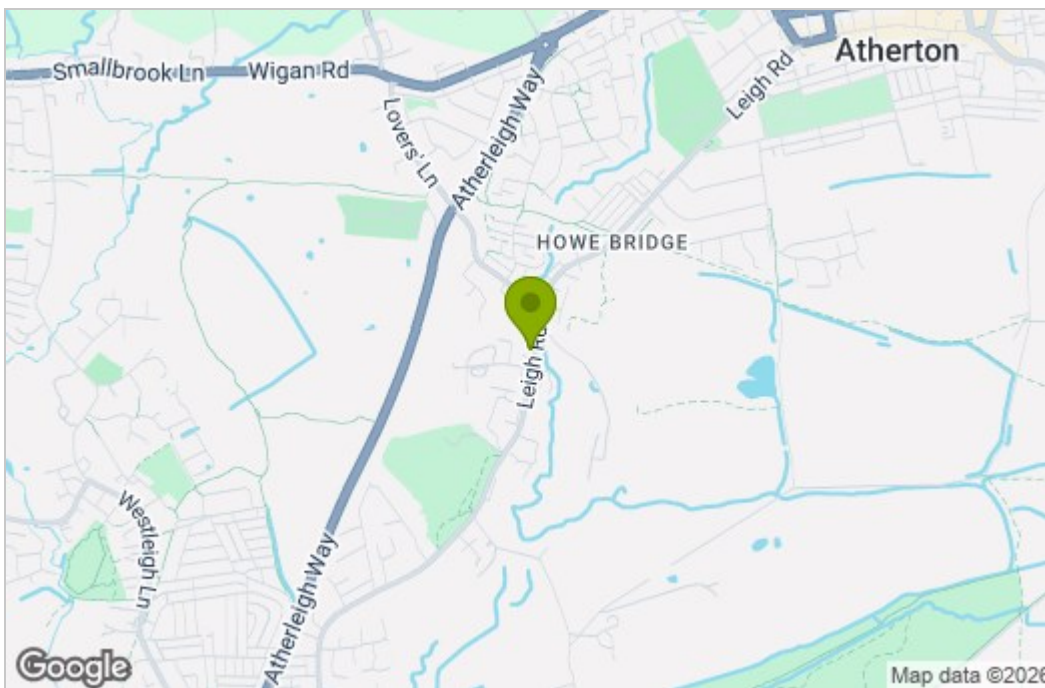

Energy Efficiency Graph

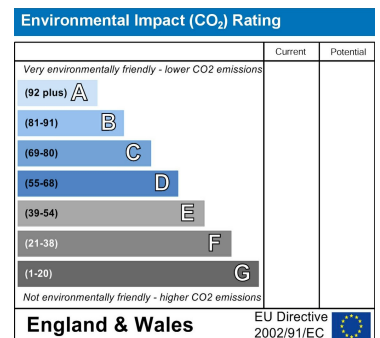
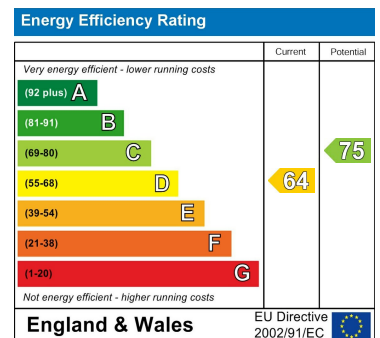

These particulars, whilst believed to be accurate are set out as a general outline only for guidance and do not constitute any part of an offer or contract. Intending purchasers should not rely on them as statements of representation of fact, but must satisfy themselves by inspection or otherwise as to their accuracy. No person in this firm's employment has the authority to make or give any representation or warranty in respect of the property.